

Angolo scorrevole a quattro ante

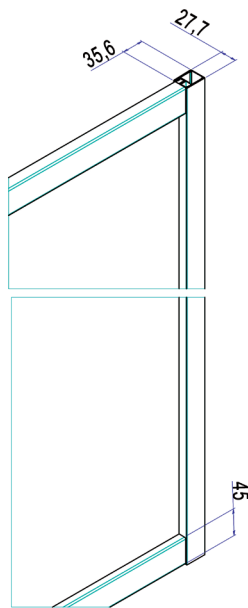

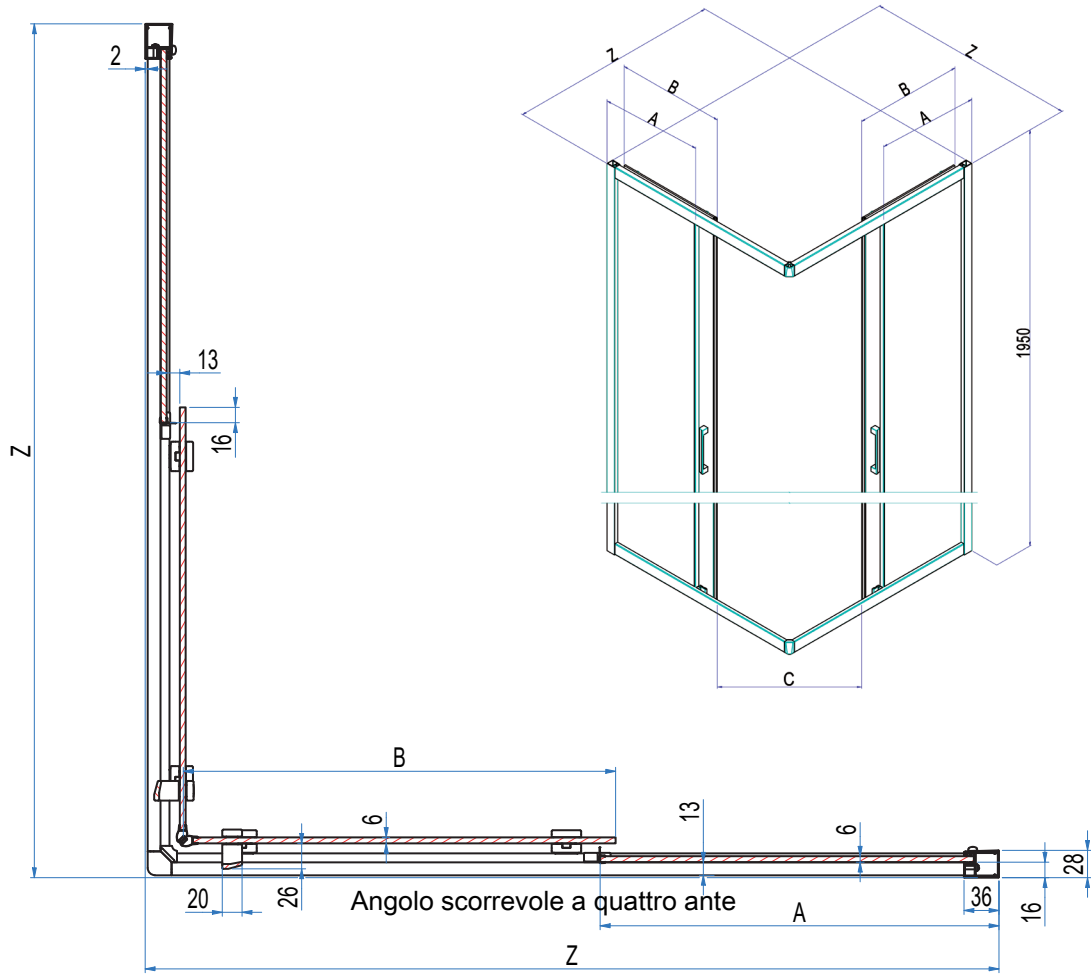

- | | | | | |
|---------------|----------------|-----------------|-----------------|-----------------|
| | | | | |
| N°3
ø 6x30 | N°2
ø M4x16 | N°3
ø 3.9x38 | N°2
ø 3.9x13 | N°4
ø 3.9x25 |

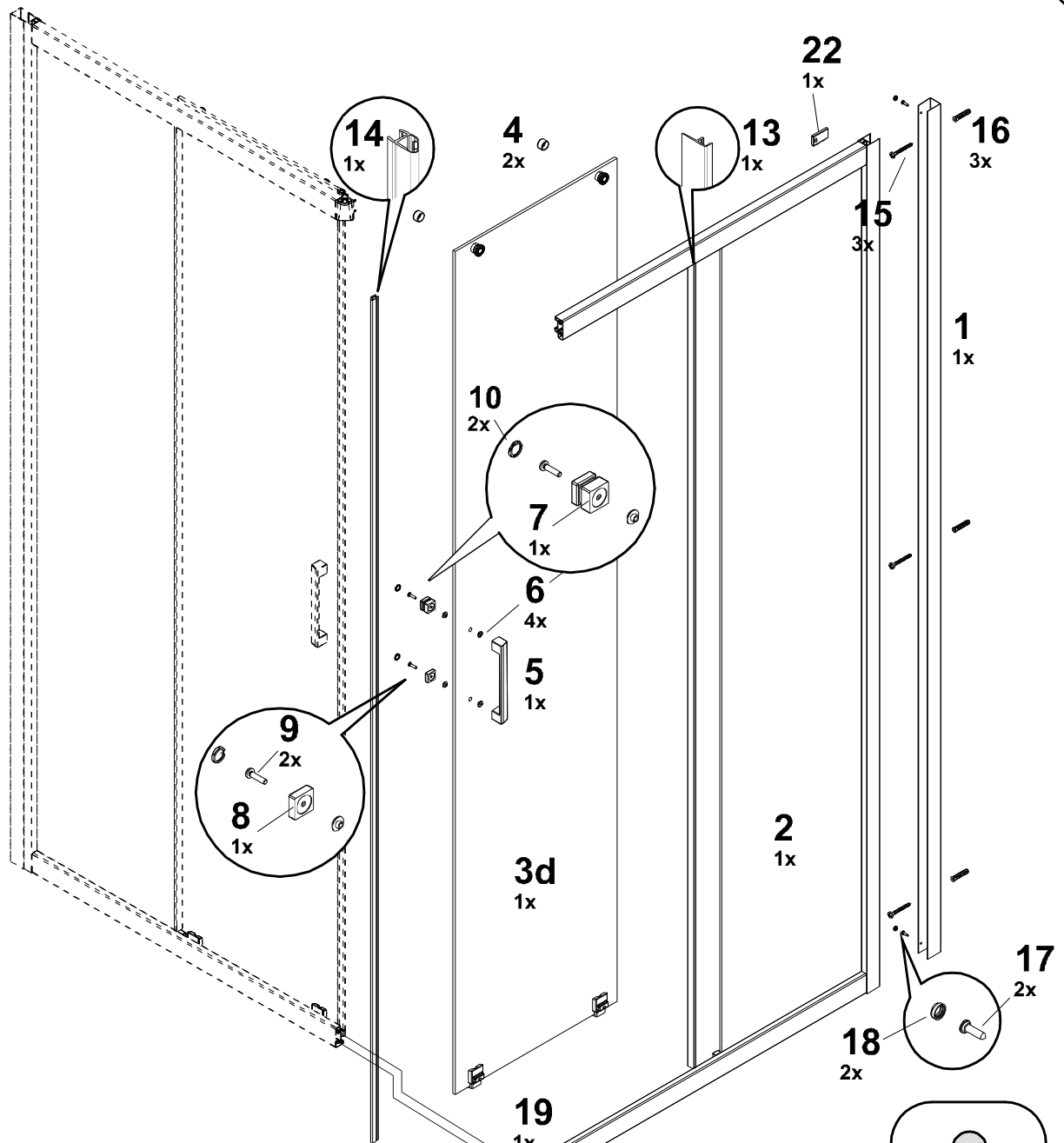
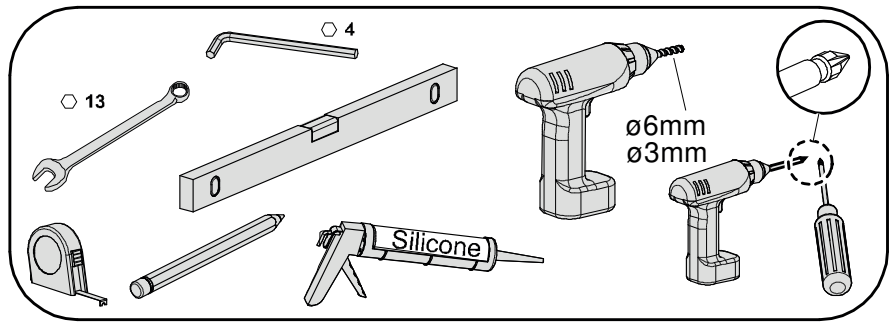
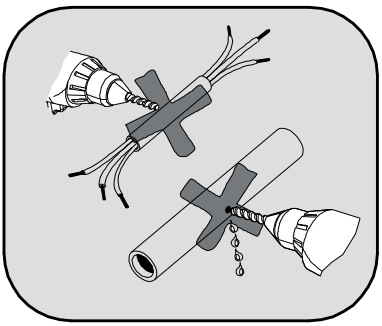
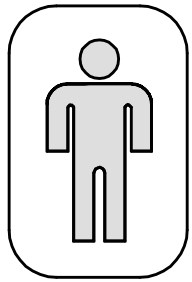

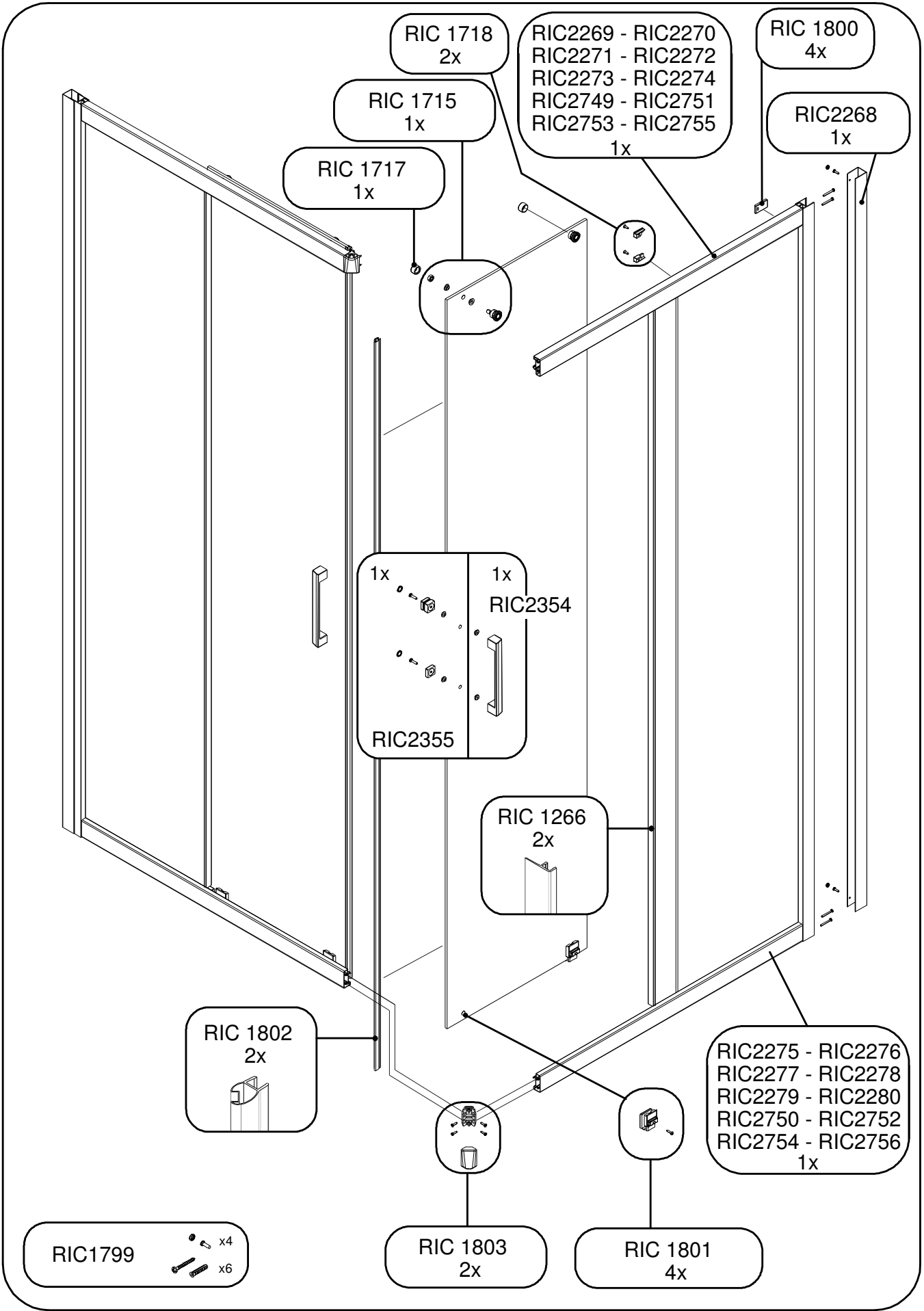

RIC 1799

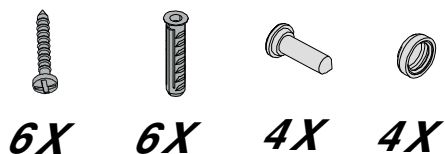

RIC 1266



RIC 1802

2X

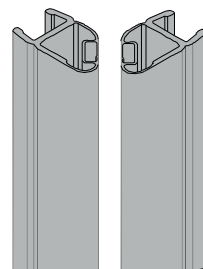

RIC 2275_ - B0916
RIC 2276_ - B0917
RIC 2277_ - B0918
RIC 2278_ - B0920
RIC 2279_ - B0921
RIC 2280_ - B0923
RIC 2750_ - B0914
RIC 2752_ - B0915
RIC 2754_ - B0919
RIC 2756_ - B0922

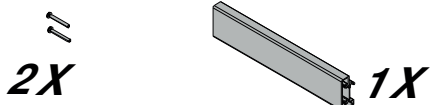

RIC 2269_ - B0916
RIC 2270_ - B0917
RIC 2271_ - B0918
RIC 2272_ - B0920
RIC 2273_ - B0921
RIC 2274_ - B0923
RIC 2749_ - B0914
RIC 2751_ - B0915
RIC 2753_ - B0919
RIC 2755_ - B0922

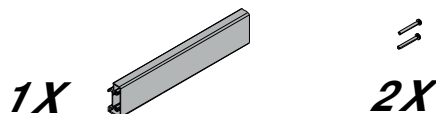

RIC 2268

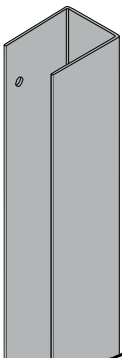

RIC 2354

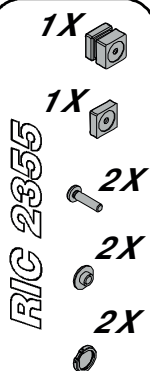
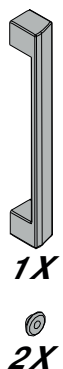

RIC 1800

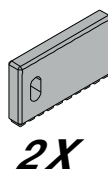

RIC 1718

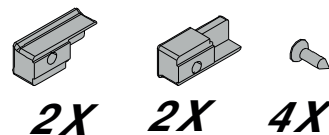

RIC 1803

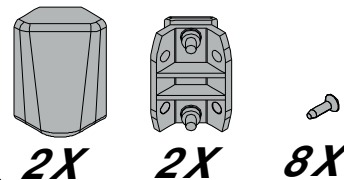

RIC 1715

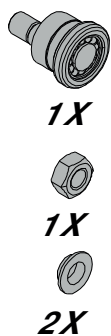

RIC 1717

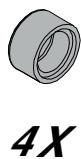

RIC 1801

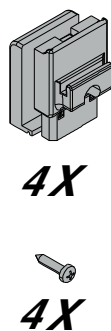

RIC 1128

